



OCTASQUARED WRAP CONTOUR COMBO ELECTRICAL

OT2-WACB0405-EL



OCTASQUARED WRAP CONTOUR COMBO ELECTRICAL - OT2-WACB0405-EL

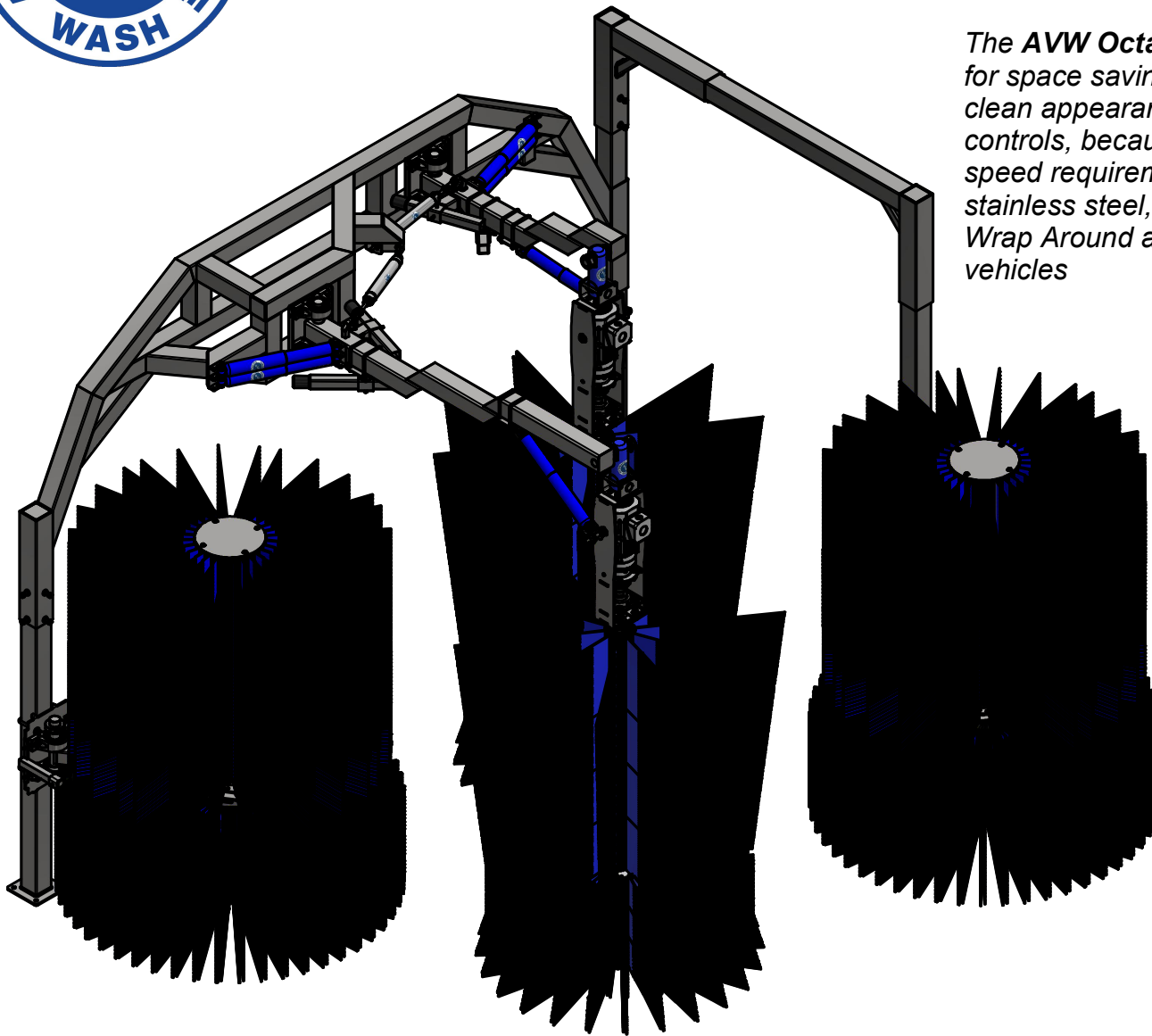

The AVW OctaSquared Wrap Contour Combo Electrical is ideal for space savings in short tunnels and where a sleek, inviting, and clean appearance is desired in longer tunnels. No complicated controls, because of the design it can self adjust to most conveyor speed requirements. Simple design Constructed of heavy grade stainless steel, the contours are designed to rotate reverse of the Wrap Around and to provide constant pressure to the side of vehicles

2 of 23



OCTASQUARED WRAP CONTOUR COMBO ELECTRICAL - OT2-WACB0405-EL

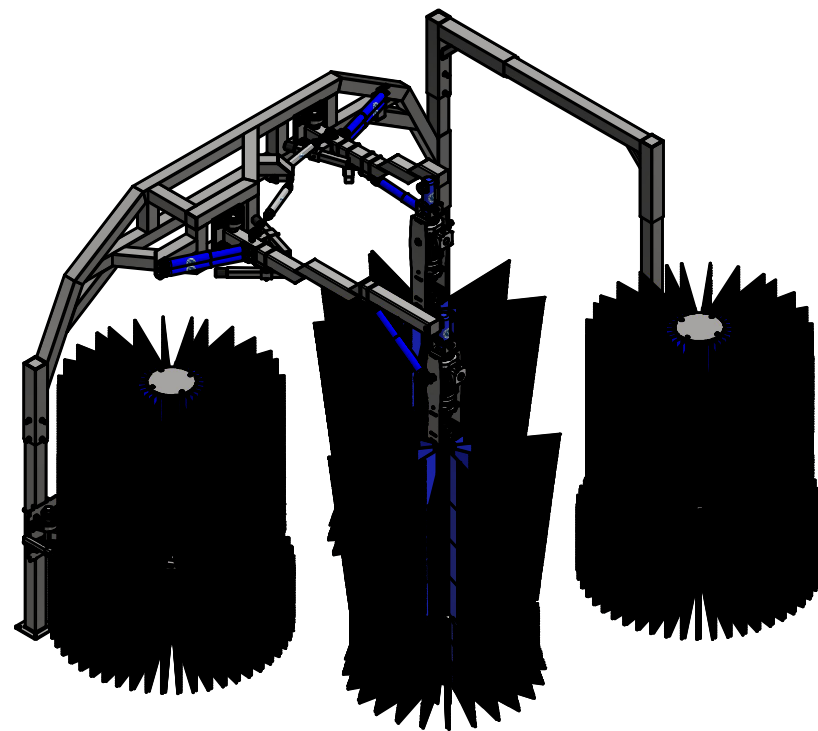
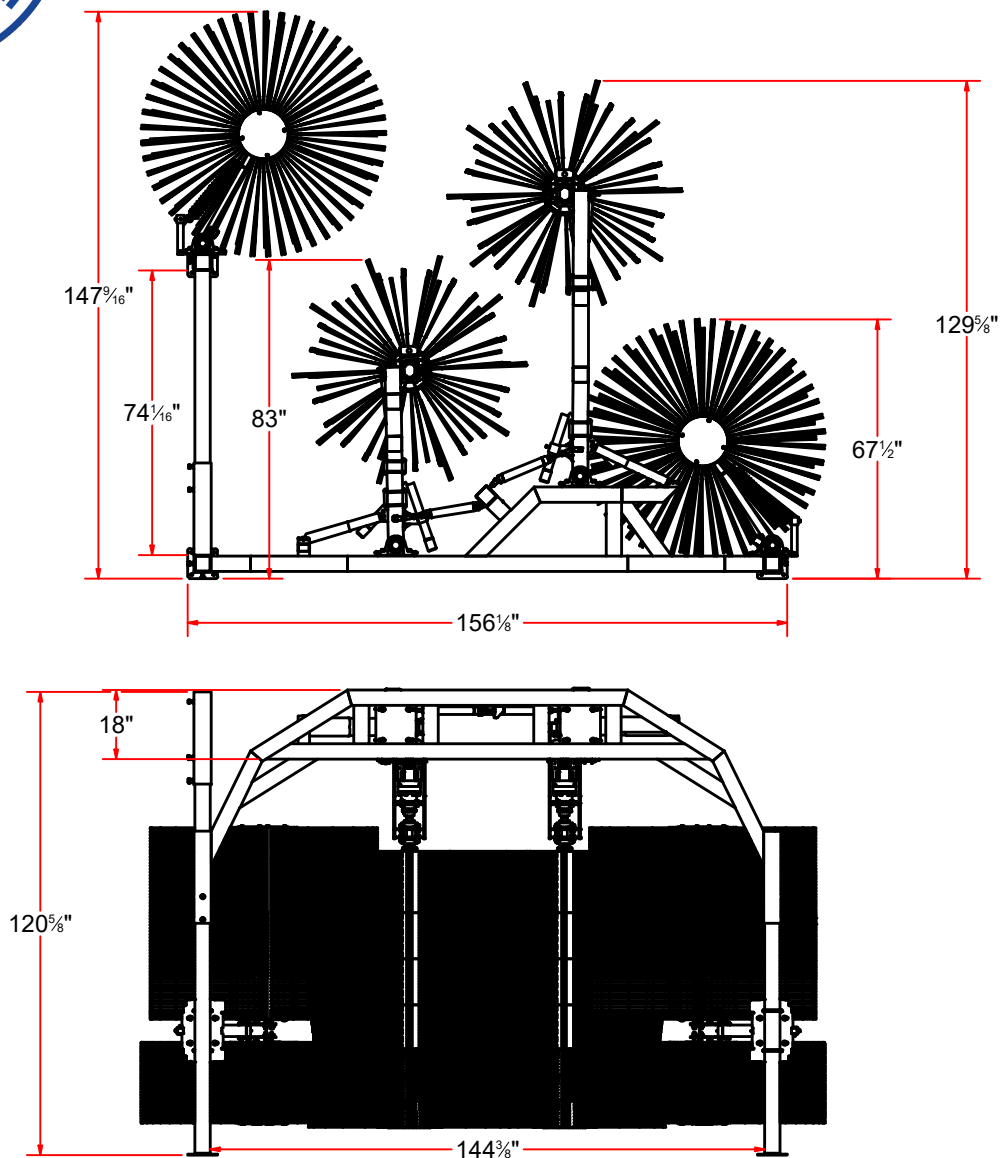

3 of 23



OCTASQUARED WRAP CONTOUR COMBO ELECTRICAL - OT2-WACB0405-EL

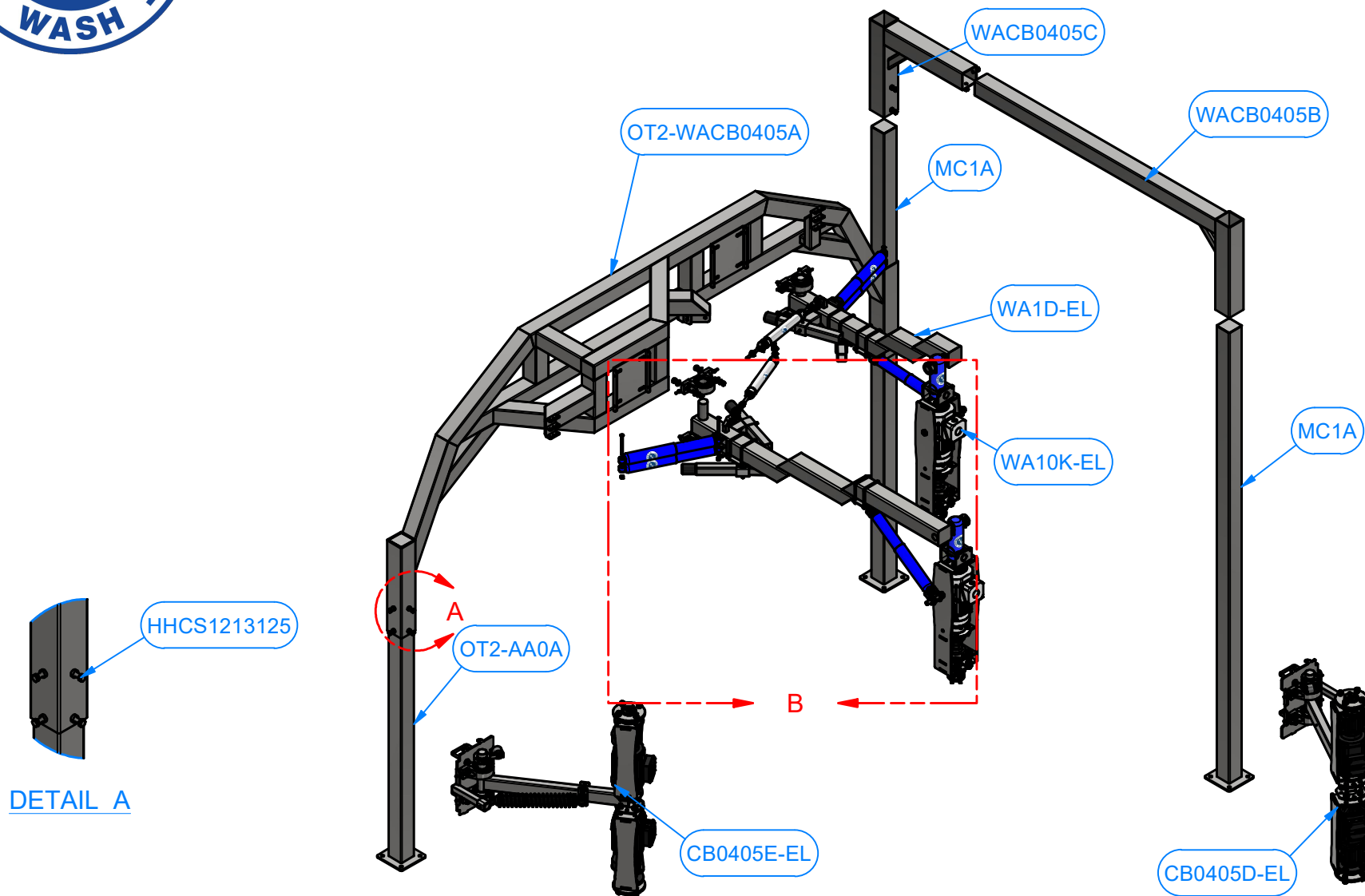

4 of 23



OCTASQUARED WRAP CONTOUR COMBO ELECTRICAL - OT2-WACB0405-EL

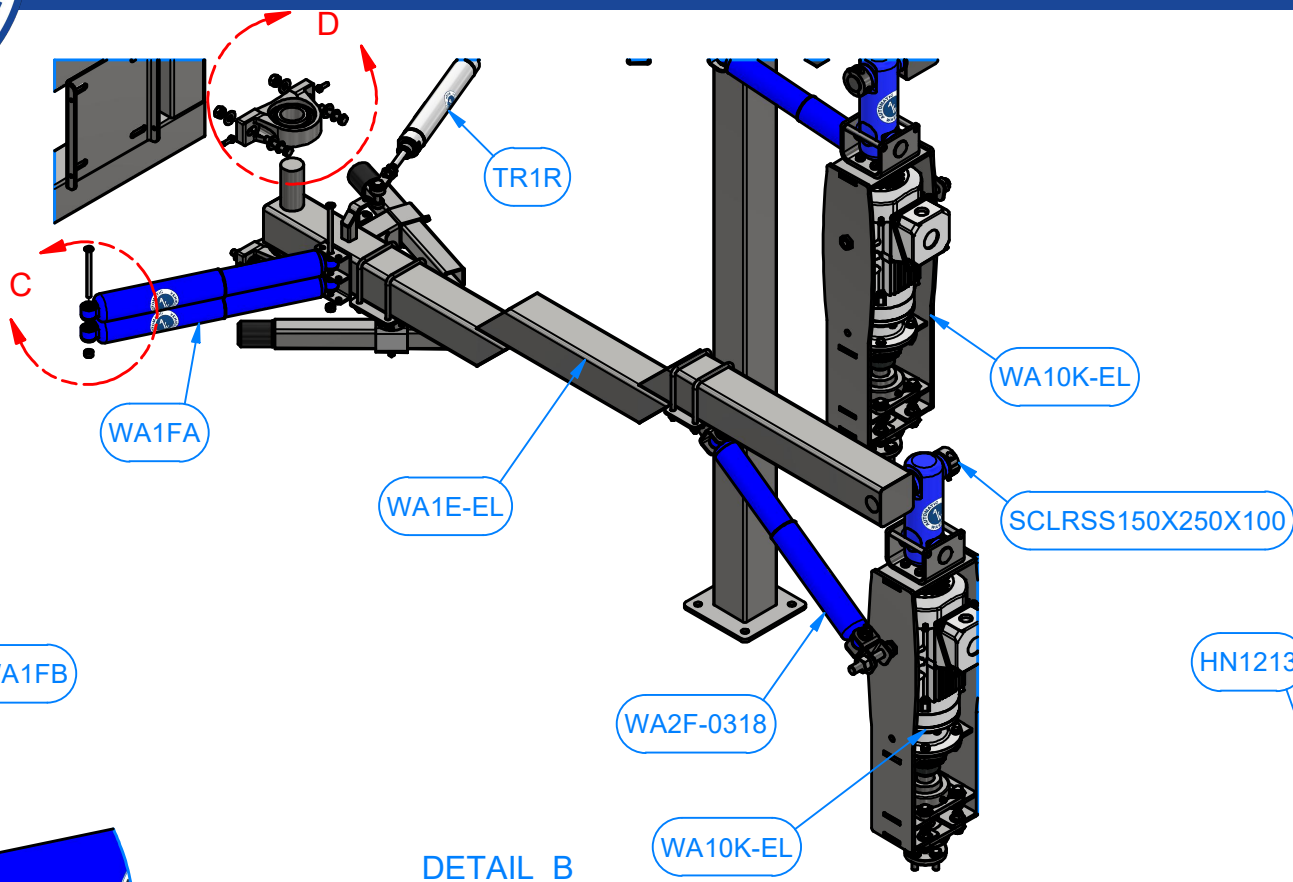

DETAIL C

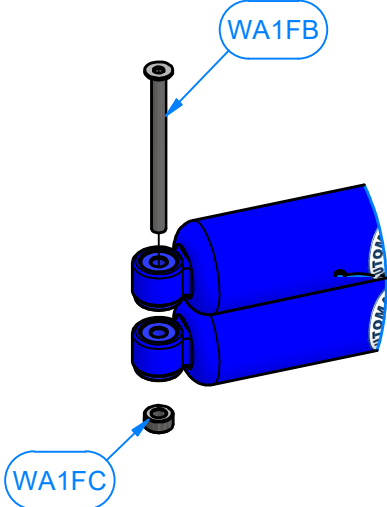

DETAIL B

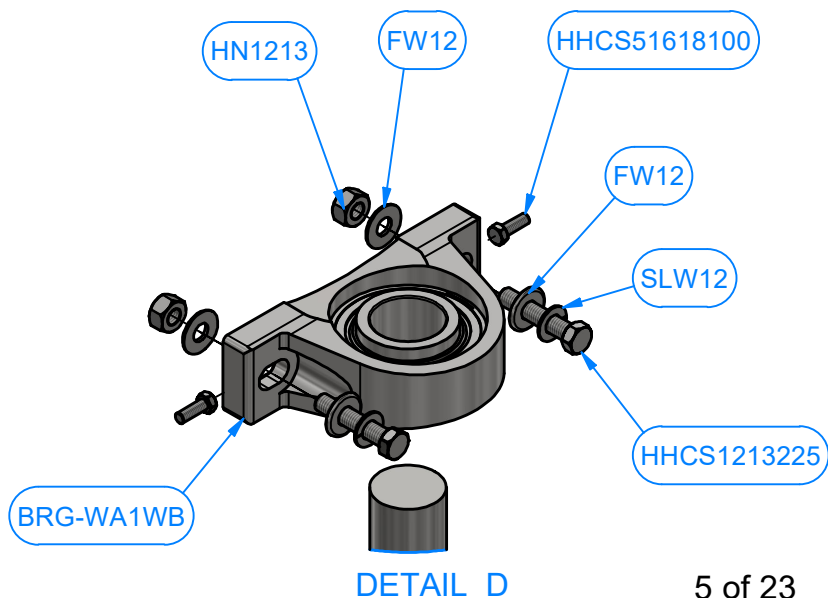



OCTASQUARED WRAP CONTOUR COMBO ELECTRICAL - OT2-WACB0405-EL

Parts List		
PART NUMBER	QTY	DESCRIPTION
OT2-WACB0405A	1	Octasquared Z-Wrap Crossbar
OT2-AA0A	1	Octasquare Empty Arch Leg - 84" LG.
HHCS1213125	20	1/2" - 13 x 1.25" UNC Hex Screw
WACB0405B	1	74" LG.Extension Arm-Weldment
BRG-WA1WB	4	2" Pillow Block
HHCS51618100	8	5/16"-18 x 1" L Hex Screw
HHCS1213225	8	1/2"-13UNCx 2 1/2"LG.HexScrew
FW12	16	1/2" Flat Washer
HN1213	8	1/2-13 Hex Nut
WA1FA	4	Shock Absorber W/ UHMW 3/8" ID
WA1FB	4	Pin 3/8" x 5" LG
WA1FC	4	3/8" Set Screw Collar
TR1R	2	Retract Air Cylinder 2" x 10" (OPTIONAL)
MC1A	2	Sq. Leg Straight 120" LG
WACB0405C	1	4 1_2" 24LG Sleeves Assy
WA10K-EL	2	Sumitotmo Electric Drive
SCLRSS150X250X100	2	1 1/2" ID Split Collar
WA2F-0318	2	Wrap Stabilizer Kit (OPTIONAL)
WA1E-EL	1	Dual Step-Up Wrap Arm (Passenger Side 76")
WA1D-EL	1	Dual Step-Up Wrap Arm (Driver 48") Assembly
CB0405E-EL	1	PASSENGER SIDE ARM ASSEMBLY [ELECTRIC]
CB0405D-EL	1	DRIVER SIDE ARM ASSEMBLY [ELECTRIC]
SLW12	8	1/2" Split Lock Washer



Dual Step Up Wrap Arm Assembly (Driver Side 48") - WA1D-EL

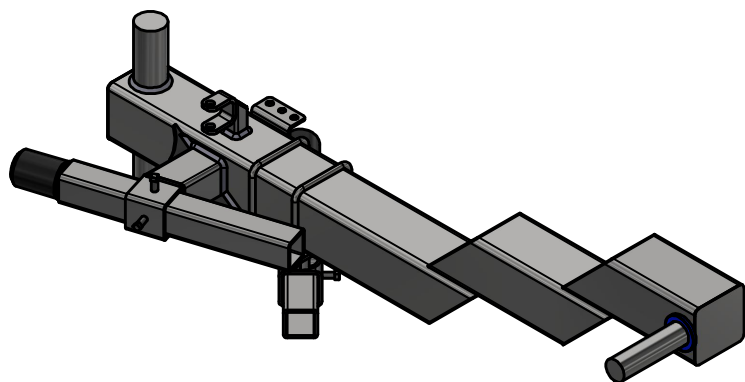

Parts List		
PART NUMBER	QTY	DESCRIPTION
WA1DA - EL	1	Dual Step-Up Wrap Arm (Driver) 48" LG
WA3DB-2639	1	Adjustable Z Wrap Bumper
WA1DB	1	Rubber Bumper Stop Assembly
WA1DBBS-S	1	UHMW Weld Cover

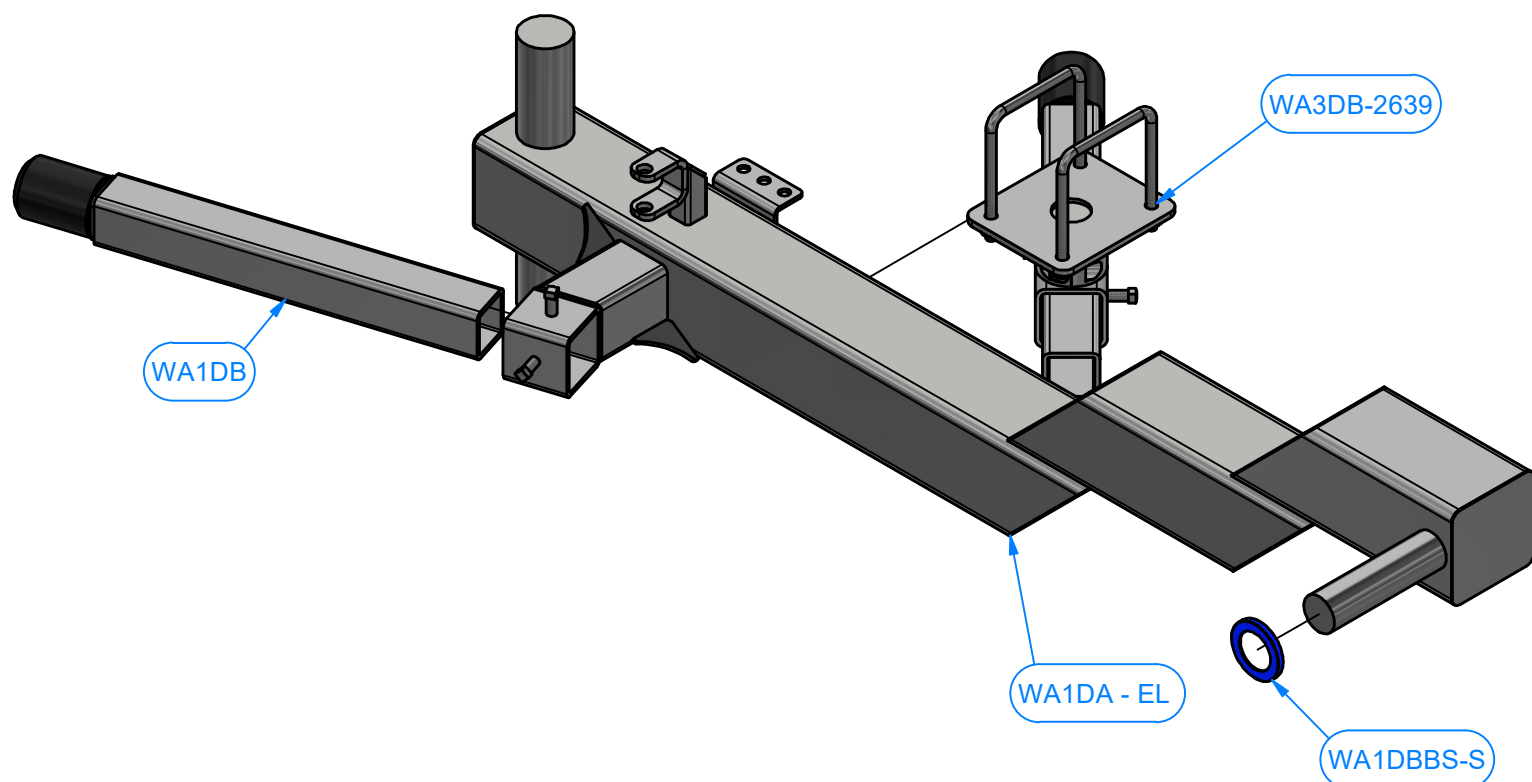



Dual Step-Up Wrap Arm (Passenger Side 76") - WA1E-EL

Parts List		
PART NUMBER	QTY	DESCRIPTION
WA1EA-EL	1	Dual Step-Up Wrap Arm (Passenger) 76" LG
WA1DBBS-S	1	UHMW Weld Cover
WA1DB	1	Rubber Bumper Stop Assembly
WA3DB	1	Adjustable Z Wrap Bumper

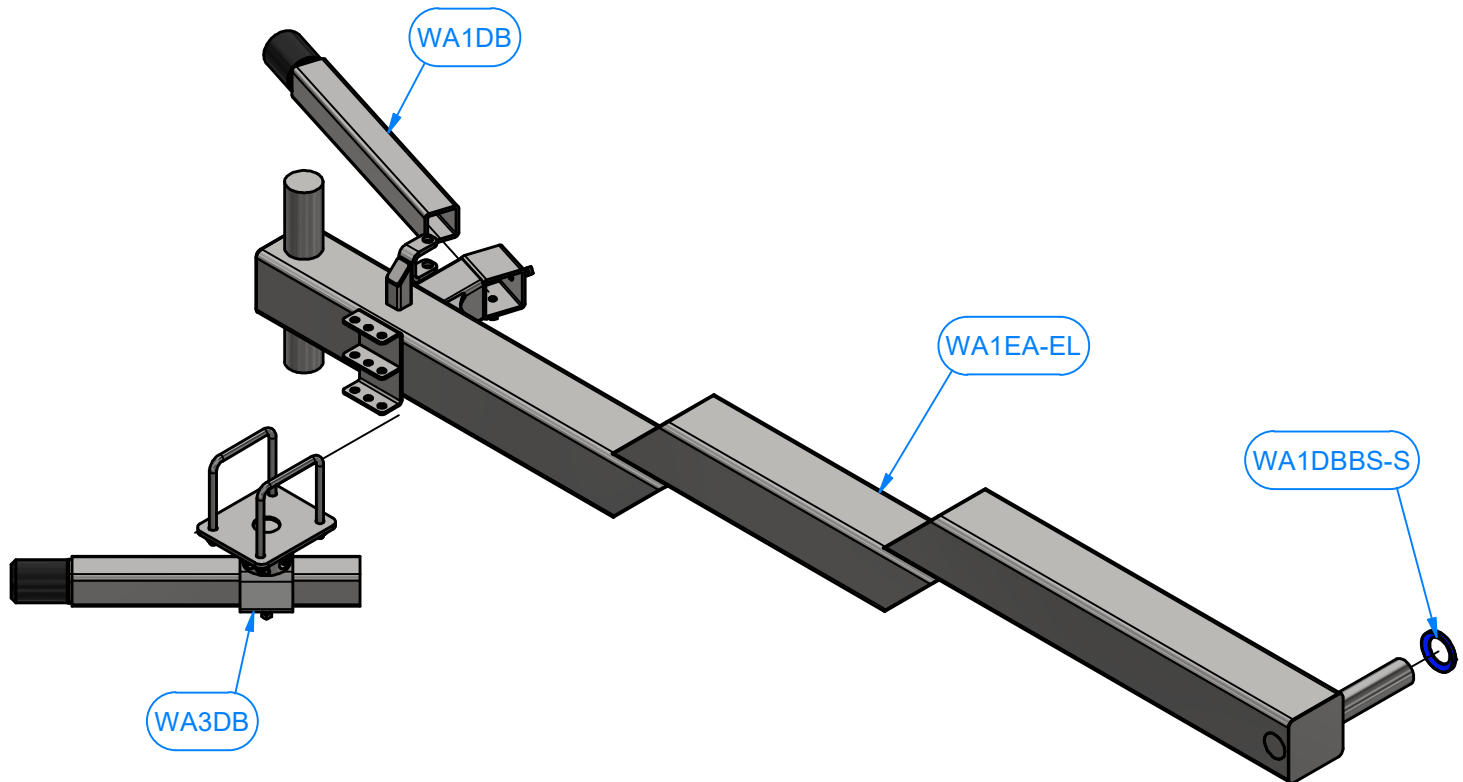
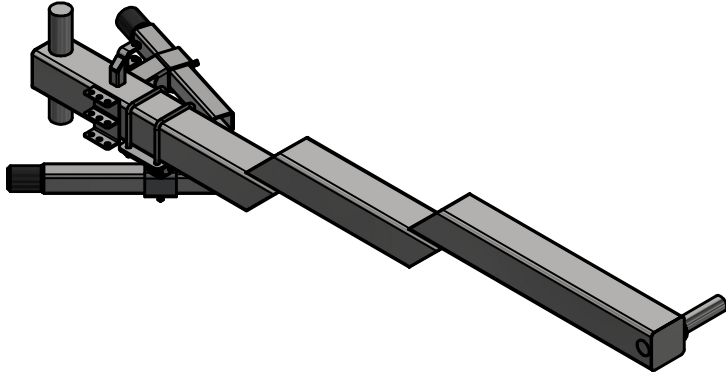



Adjustable Z Wrap Arm Bumper - WA3DB-2639

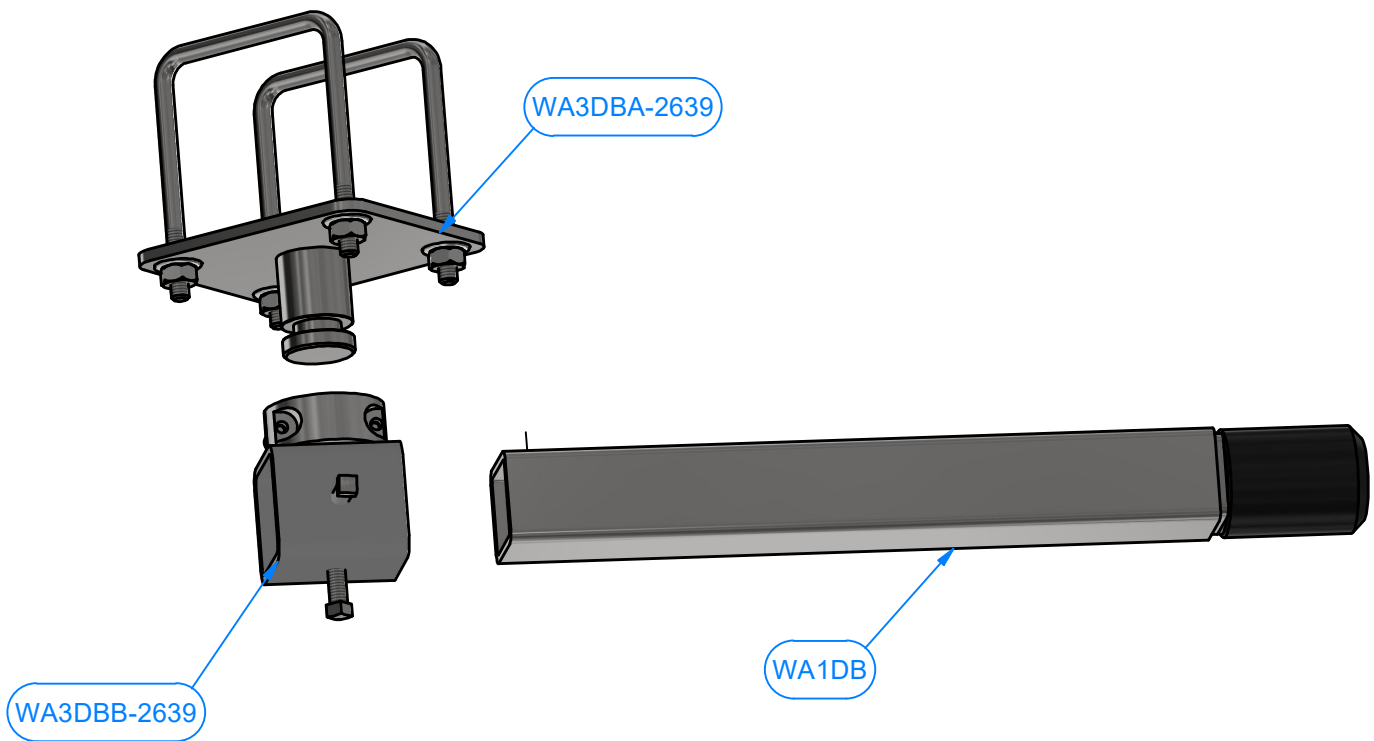

Parts List		
PART NUMBER	QTY	DESCRIPTION
WA3DBA-2639	1	Adjustable Plate Assembly
WA3DBB-2639	1	Adjustable Sleeve Assembly
WA1DB	1	Rubber Bumper Stop Assembly



WRAP STABILIZER KIT (OPTIONAL) - WA2F-0318

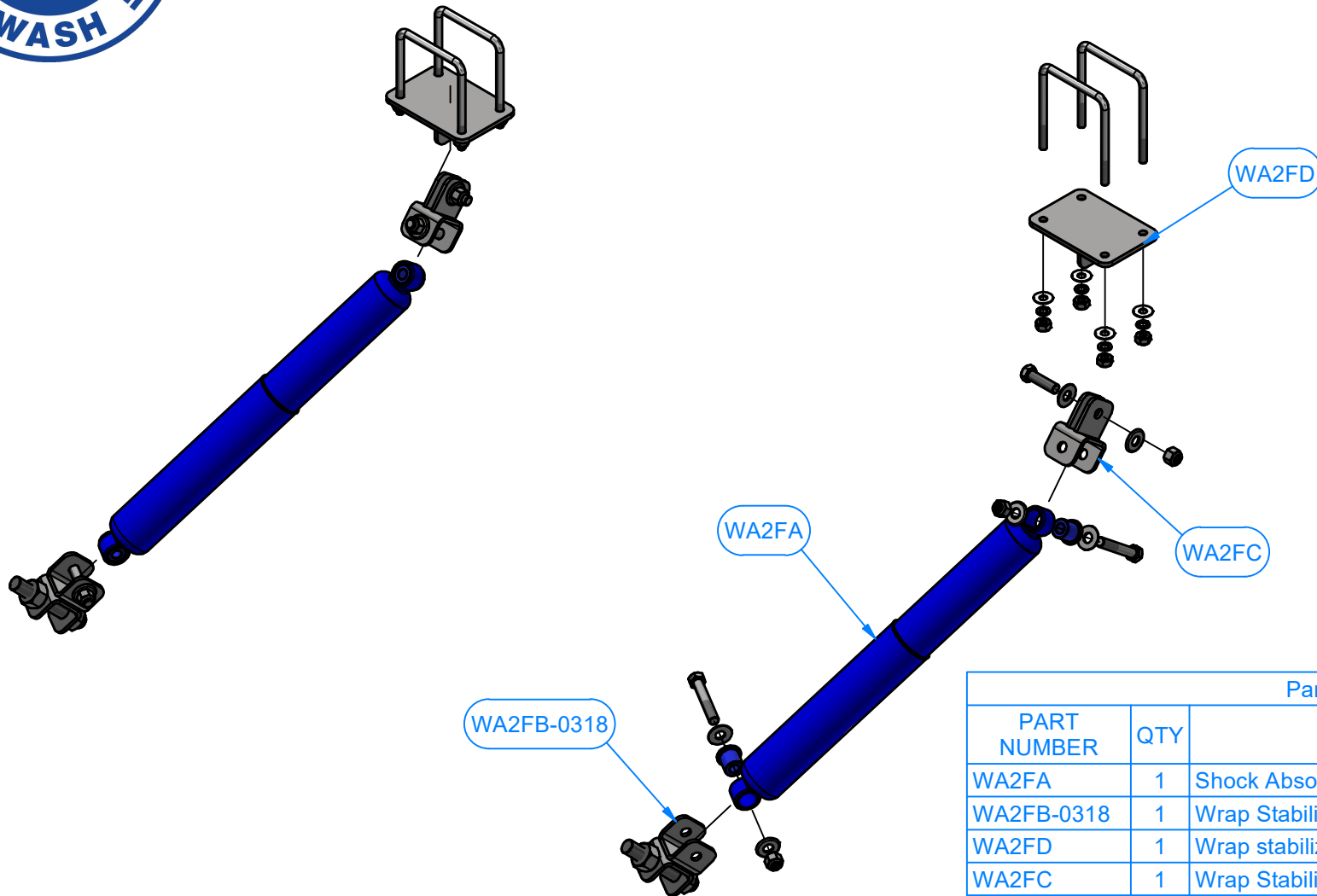

Parts List		
PART NUMBER	QTY	DESCRIPTION
WA2FA	1	Shock Absorber W/ UHMW 3/8" ID
WA2FB-0318	1	Wrap Stabilizer Front Mount
WA2FD	1	Wrap stabilizer rear bracket mount
WA2FC	1	Wrap Stabilizer Rear Mount Clevis Assembly



Retract and Dual Air Assist Kit (OPTIONAL) - WA1-SK-2018

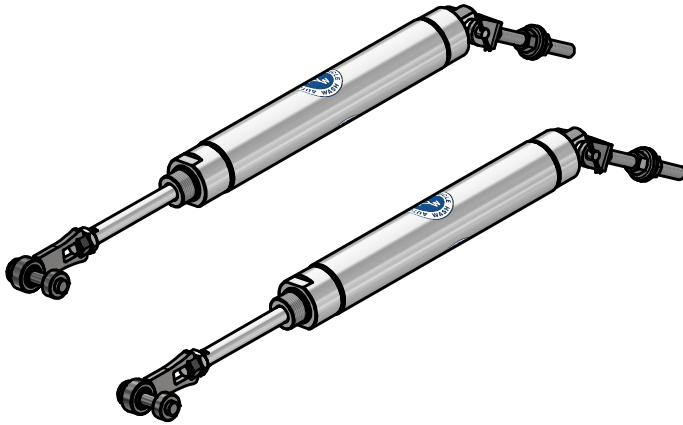

[WA1GA-](#) 2xAir Cylinder Assembly(TR1R)

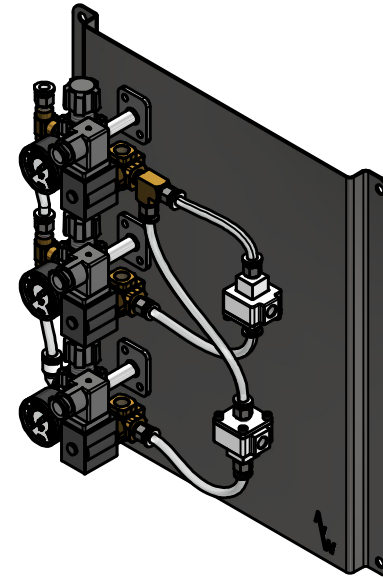

[WA1-SKP-2018](#) - Air Assist Panel

Note:

Kit Includes two Air Cylinder Assemblies and one Air Assist Panel



Retract Air Cylinder 2" x 10" (OPTIONAL) - TR1R

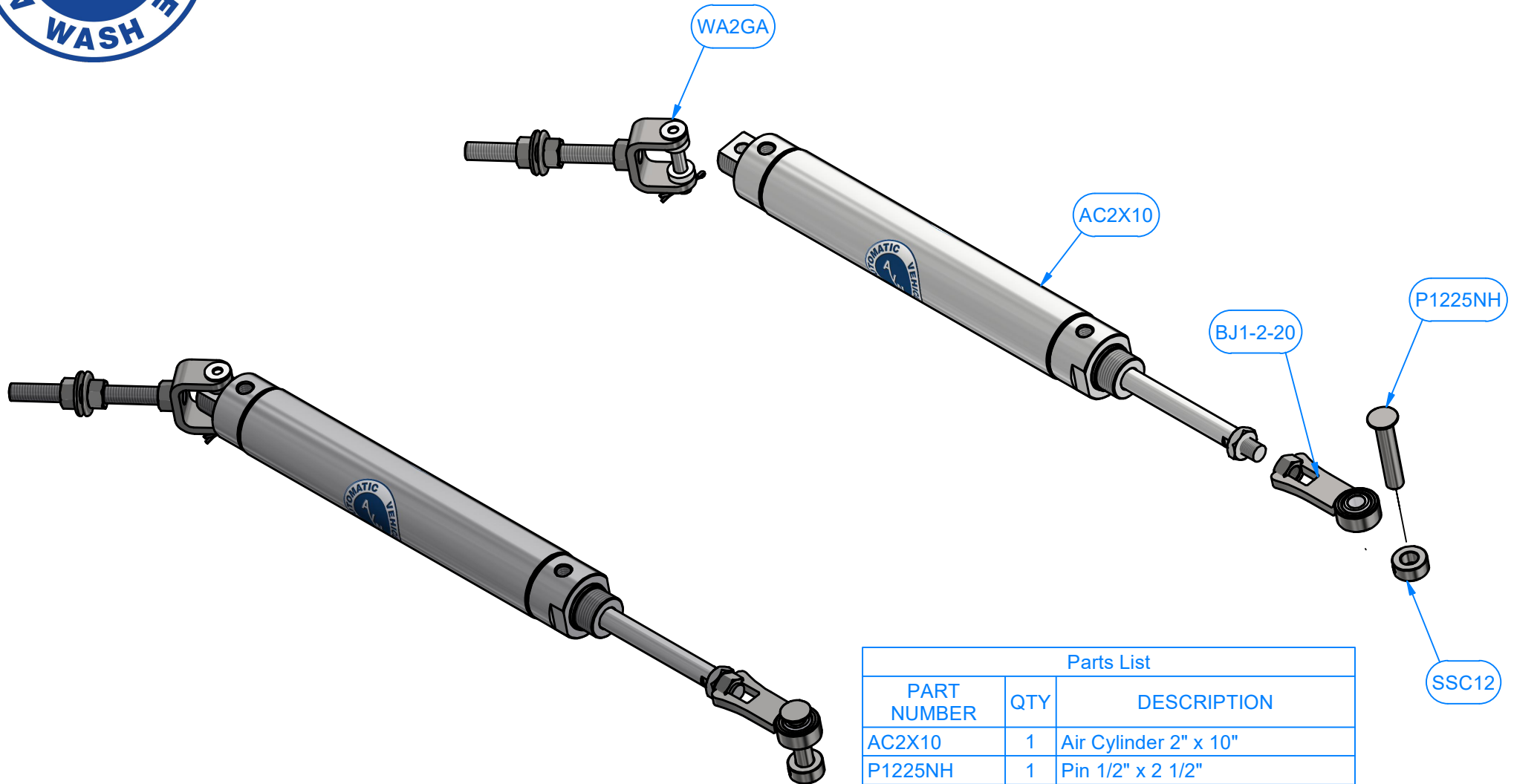

Parts List		
PART NUMBER	QTY	DESCRIPTION
AC2X10	1	Air Cylinder 2" x 10"
P1225NH	1	Pin 1/2" x 2 1/2"
SSC12	1	1/2" Set Screw Collar
WA2GA	1	Retract kit Rear Mounting Assy
BJ1-2-20	1	Ball Joint End Rod

12 of 23



Air Assist & Retract Kit Panel (OPTIONAL) - WA1-SKP-2018

Parts List		
PART NUMBER	QTY	DESCRIPTION
AREG1-4-R-SMC	3	Air Regulator
NPLBR025HEX	5	Hex Nipple 1/4" NPT
SL1-4-SMC-120-3220	3	3 Way Directional Valve 1/4" NPT w/ Solenoid
AREG1-G14	3	0-160 PSI Gauge 1/4"NPT
APF3814-EL90	1	90° Elbow Push-Connect Fitting 3/8"x1/4" NPT
OR25B	2	1/4" Quick Exhaust Valve
WA1-SKPB-2018	3	Sheet Metal 12 Ga. 2 1/2" x 1"
APS1SFB	3	Stand-off bracket Holder
WA1-SKPA-2018	1	Sheet Metal 14 Ga. 18" x 18"
APF3814	12	3/8" NPT Push connect fitting
TEEBR025	2	Tee(Female) 1/4" FNPT
AH3814	6	Air Hose 3/8" ODx.062 Thk
TEE-S-BR025	1	Street Tee Barstock: 1/4"NPT

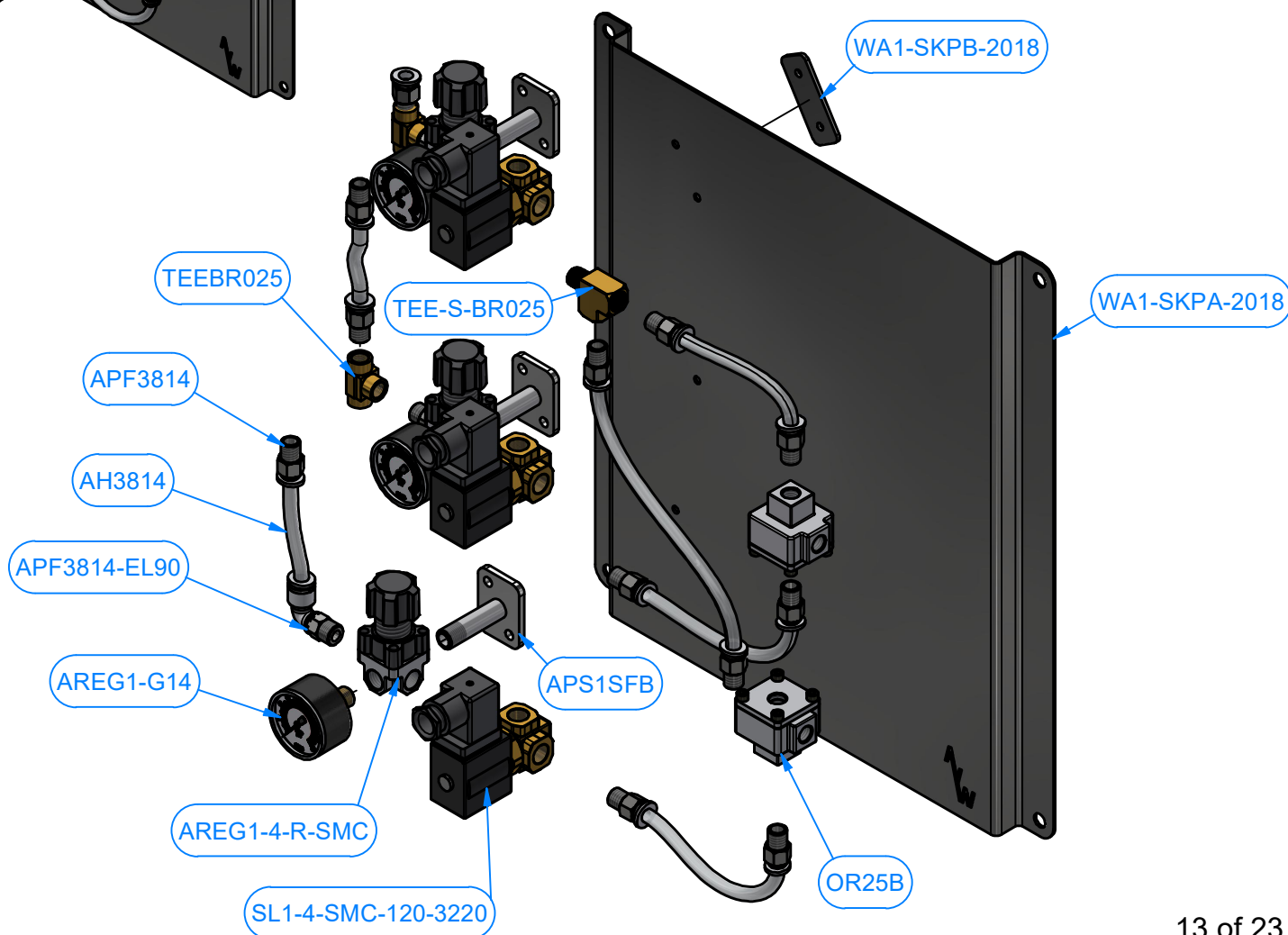
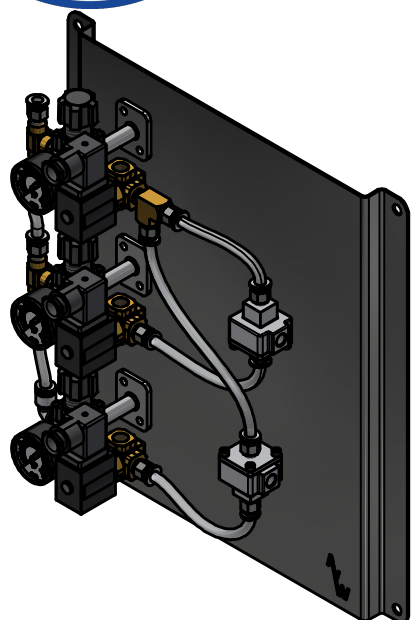



Sumitomo Electric Drive - WA10K-EL

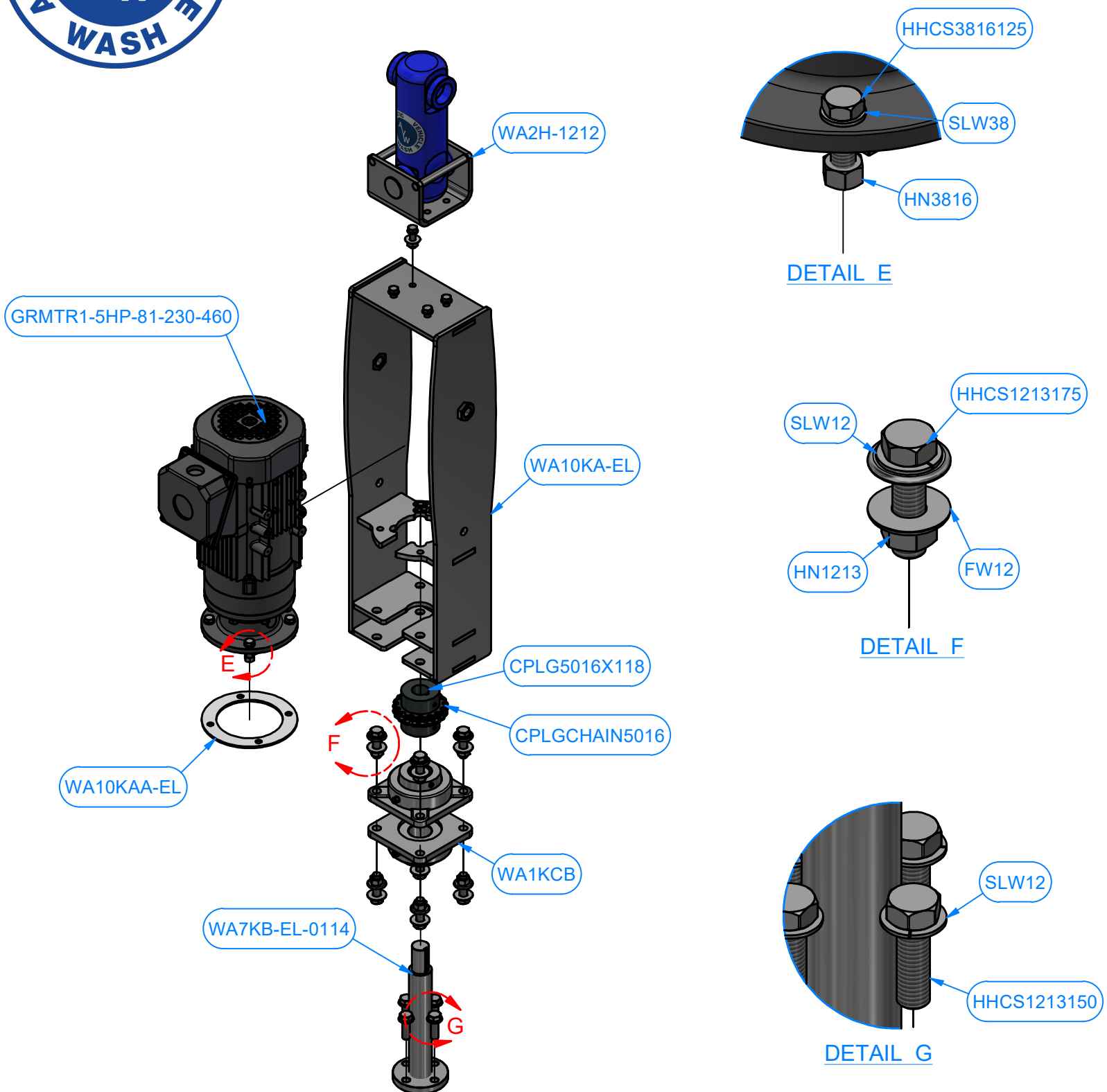



Sumitomo Electric Drive - WA10K-EL

Parts List		
PART NUMBER	QTY	DESCRIPTION
WA10KA-EL	1	Wrap Motor Mount Frame Assembly
GRMTR1-5HP-81-230-460	1	Sumitomo Gearmotor 1 1/8" Shaft
HHCS3816125	8	3/8" - 16 x 1 1/4" UNC Hex Screw
SLW38	8	3/8" Split Lock Washer
HN3816	4	Hex Nut - 3/8"-16
CPLG5016X118	2	Chain Coupling Flange 1 1/8"
WA1KCB	2	1-1/2" Flange Mount Bearing-Nickel Plated
WA7KB-EL-0114	1	Brush Stub Shaft 1 1/2" x 10" L
HN1213	8	1/2" - 13 UNC Hex Nut
FW12	16	1/2" Flat Washer
SLW12	12	1/2" Split Lock Washer
HHCS1213175	8	1/2"-13 x 1.75" L Hex Screw
CPLGCHAIN5016	1	Chain Assembly Motor-to-Shaft
HHCS1213150	4	1/2" - 13 x 1 1/2" UNC Hex Screw
WA10KAA-EL	1	SS Plate #10Gax 6 1/4" OD
HHN3816	4	3/8"-16 18-8ss Heavy Hex Nut
FW38	4	3/8" Flat Washer
WA2H-1212	1	Universal Coupling Assembly [10.375 in L]



Universal Coupling Assembly - WA2H-1212

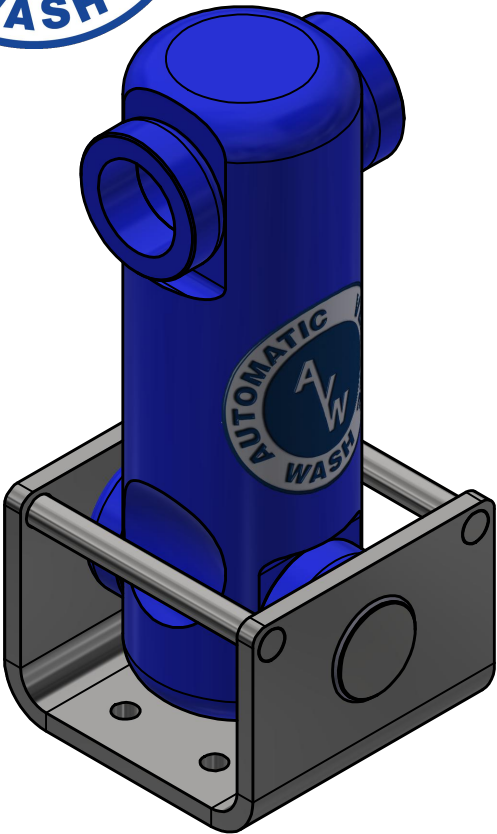

Parts List		
PART NUMBER	QTY	DESCRIPTION
WA2HC	1	Universal Coupler Base
WA2HB	1	Shaft D 1 1/2" x 5 1/8" LG
WA11-0112	4	UHMW Spacer 2 1/4" OD x 1 1/2" ID x 3/4" L
WA2HA-1212	1	UHMW Coupler 10 3/8" LG
WA11-0113	1	UHMW Washer 2 1/4"OD x 1 1/2" ID x 3/16" thk

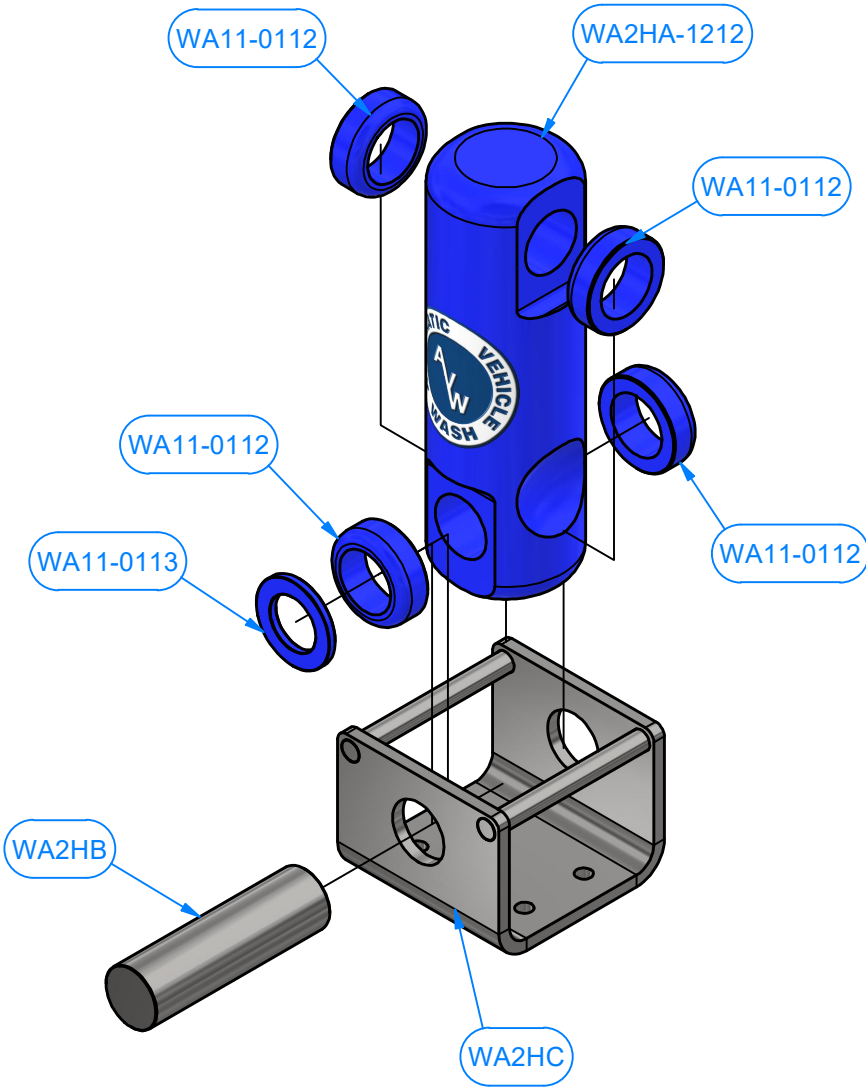



DRIVER SIDE ARM ASSEMBLY [ELECTRIC] - CB0405D-EL

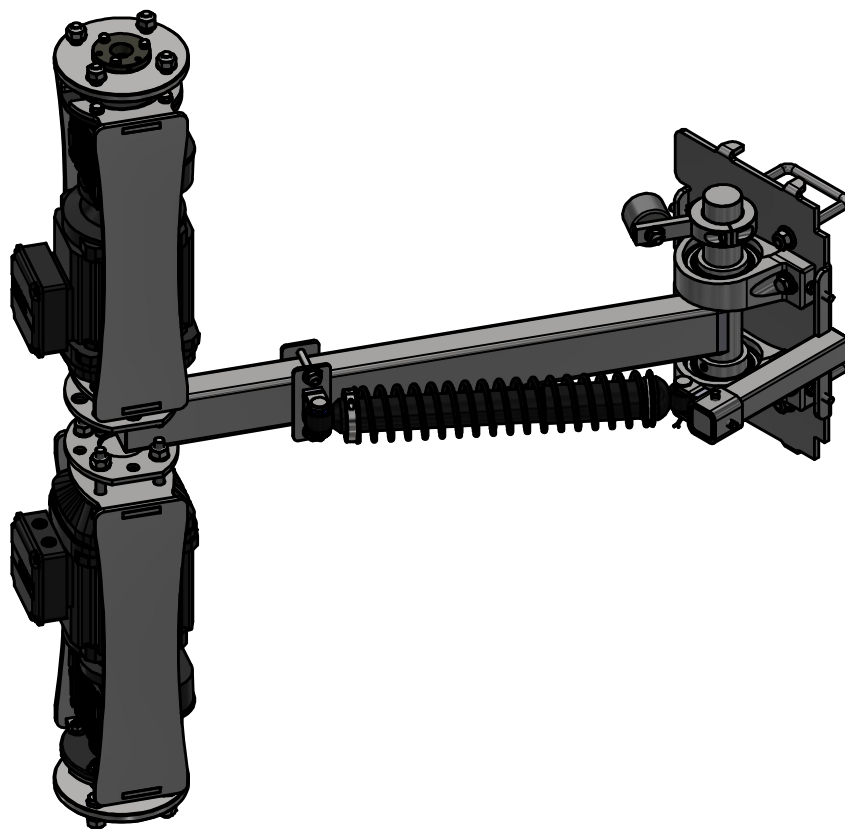

Parts List		
PART NUMBER	QTY	DESCRIPTION
CB0405DAx32	1	DRIVER ARM ASSEMBLY - Weldment
CB0405DB	1	DRIVER ARM MOUNT ASSEMBLY
WA2GA	1	Front Shock Mount
RB1AF	1	Shock Absorber Assembly
CB0405AC	1	BUMPER ASSEMBLY
RB1AE-EL	2	Brush Drive Assembly [EL]



DRIVER SIDE ARM ASSEMBLY [ELECTRIC] - CB0405D-EL

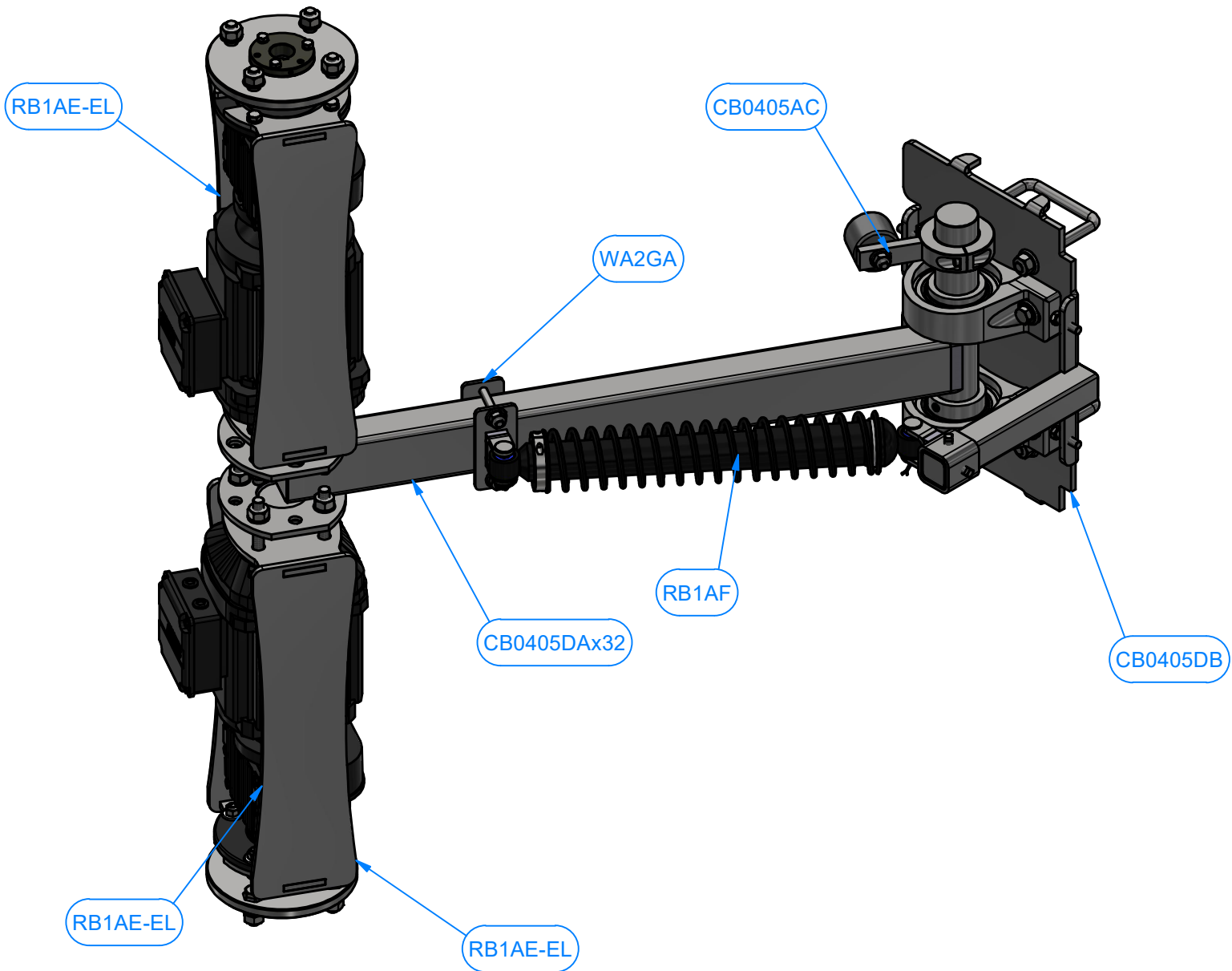



PASSENGER SIDE ARM ASSEMBLY [ELECTRIC] - CB0405E-EL

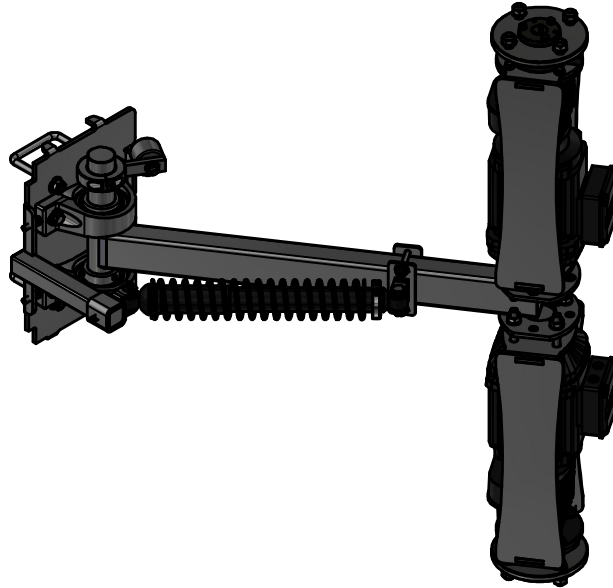

Parts List		
PART NUMBER	QTY	DESCRIPTION
CB0405EAx32	1	PASSENGER SIDE ARM ASSEMBLY - Weldment
CB0405EB	1	PASSENGER SIDE ARM MOUNT ASSY. [ELECTRIC]
WA2GA	1	Front Shock Mount
RB1AF	1	Shock Absorber Assembly
CB0405AC	1	BUMPER ASSEMBLY
RB1AE-EL	2	Brush Drive Assembly [EL]



PASSENGER SIDE ARM ASSEMBLY [ELECTRIC] - CB0405E-EL

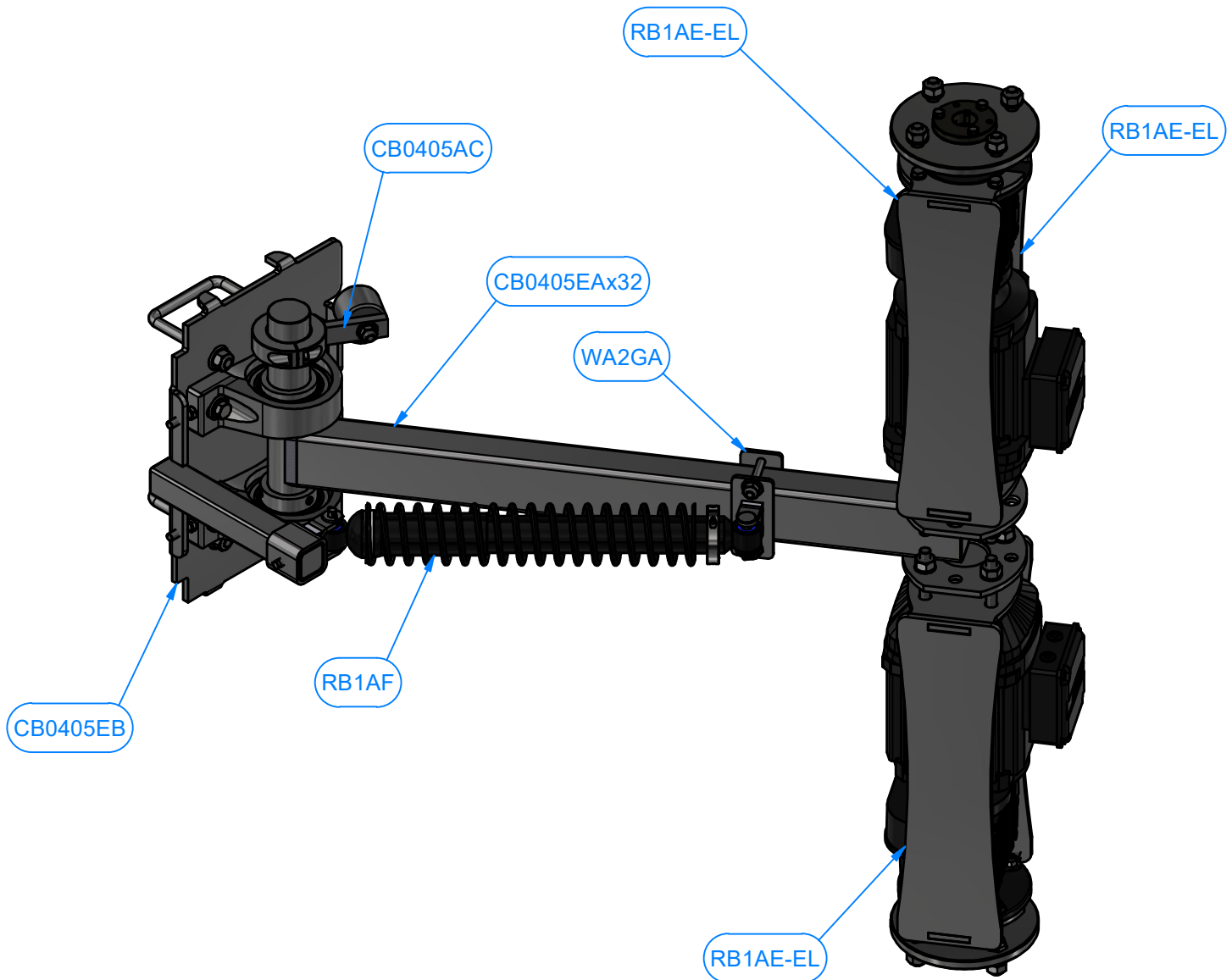



WRAP AROUND BRUSH ASSEMBLY - WA1M-5-10x72

Parts List		
PART NUMBER	QTY	DESCRIPTION
WA1M-72-510-5220-CORE	1	Wrap Around Core

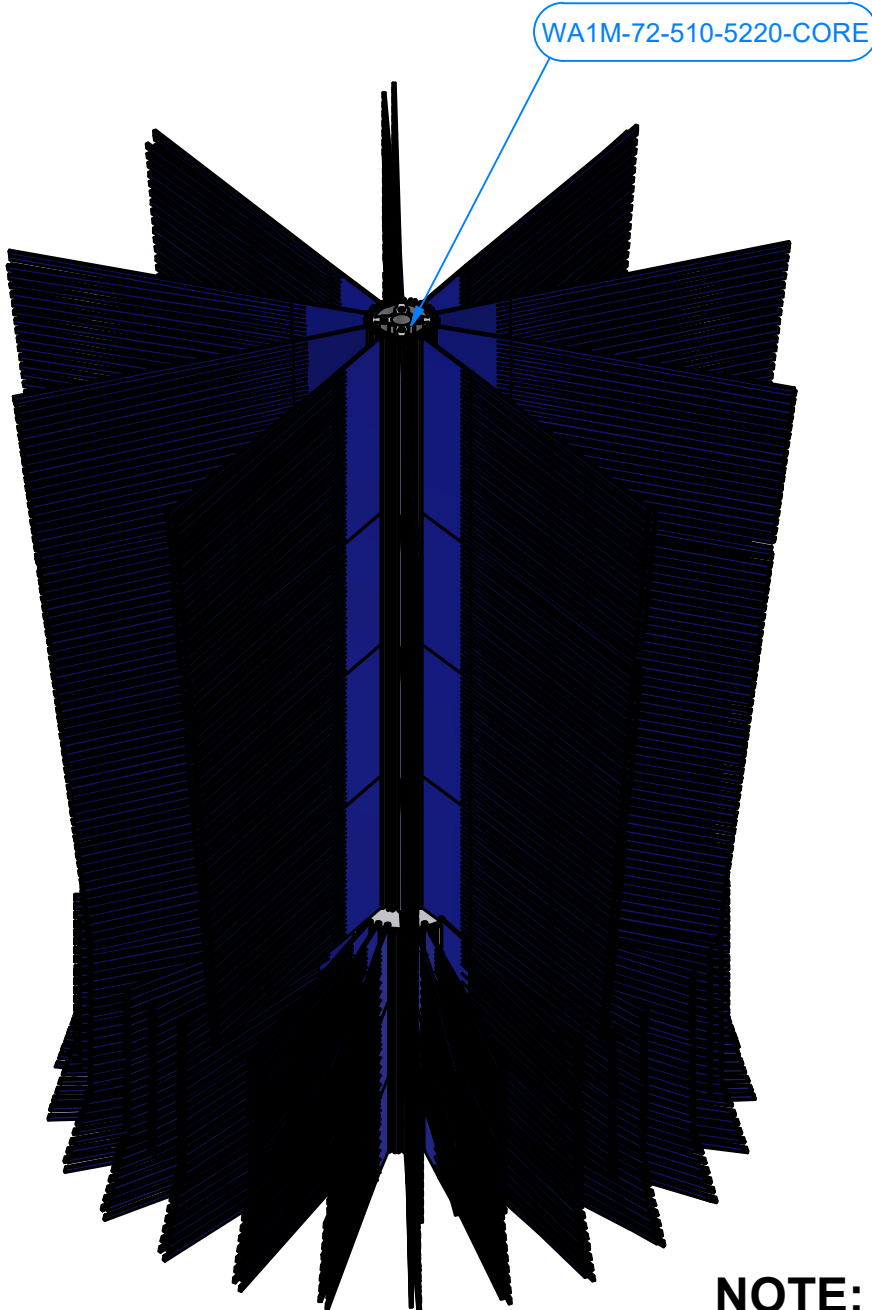

NOTE:
Brush Cloth Sold Separately



50" UPPER CONTOUR BRUSH ASSEMBLY - CB0405AM-51-12EL-S-CL

Parts List		
PART NUMBER	QTY	DESCRIPTION
CB0405AMC-51-12	1	UPPER AVW CONTOUR BRUSH CORE 51"
RPSS125X1150X4H	1	Round Plate OD 13"
CB0405AMB	4	Cloth Stopper#3/16"X 9"X2 1/2"
FW14	12	1/4" Flat Washer
HHCS1420050	12	1/4" - 20 x 0.5" UNC Hex Screw

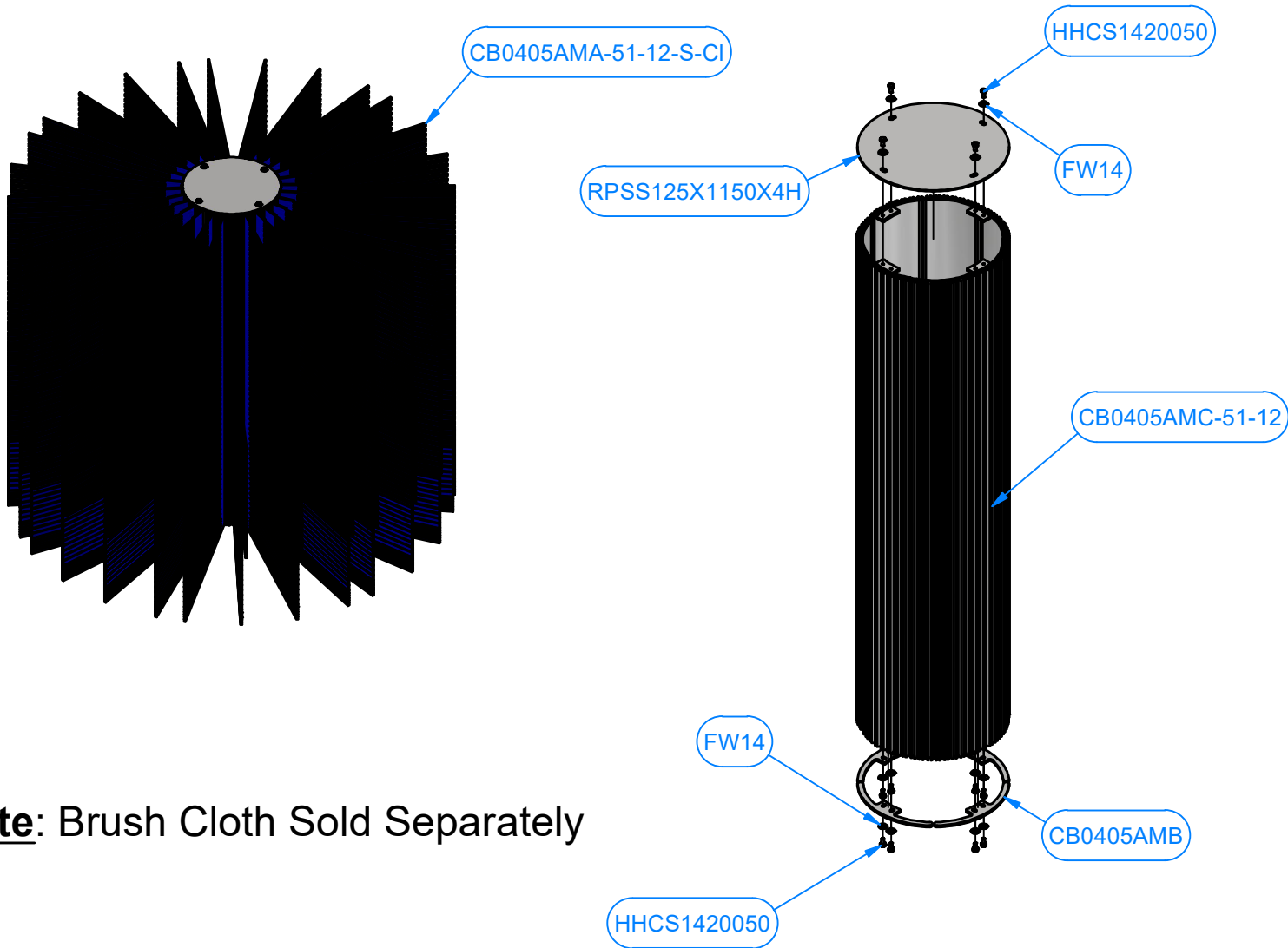

Note: Brush Cloth Sold Separately



21" LOWER BRUSH ASSEMBLY - CB0405AM-21-12-S-CL

Parts List		
PART NUMBER	QTY	DESCRIPTION
CB0405AMC-21-12	1	21" LOWER CONTOUR BRUSH CORE
CB0405AMB	4	Cloth Stopper#3/16"X 9"X2 1/2"
FW14	8	1/4" Flat Washer
HHCS1420050	8	1/4" - 20 x 0.5" UNC Hex Screw

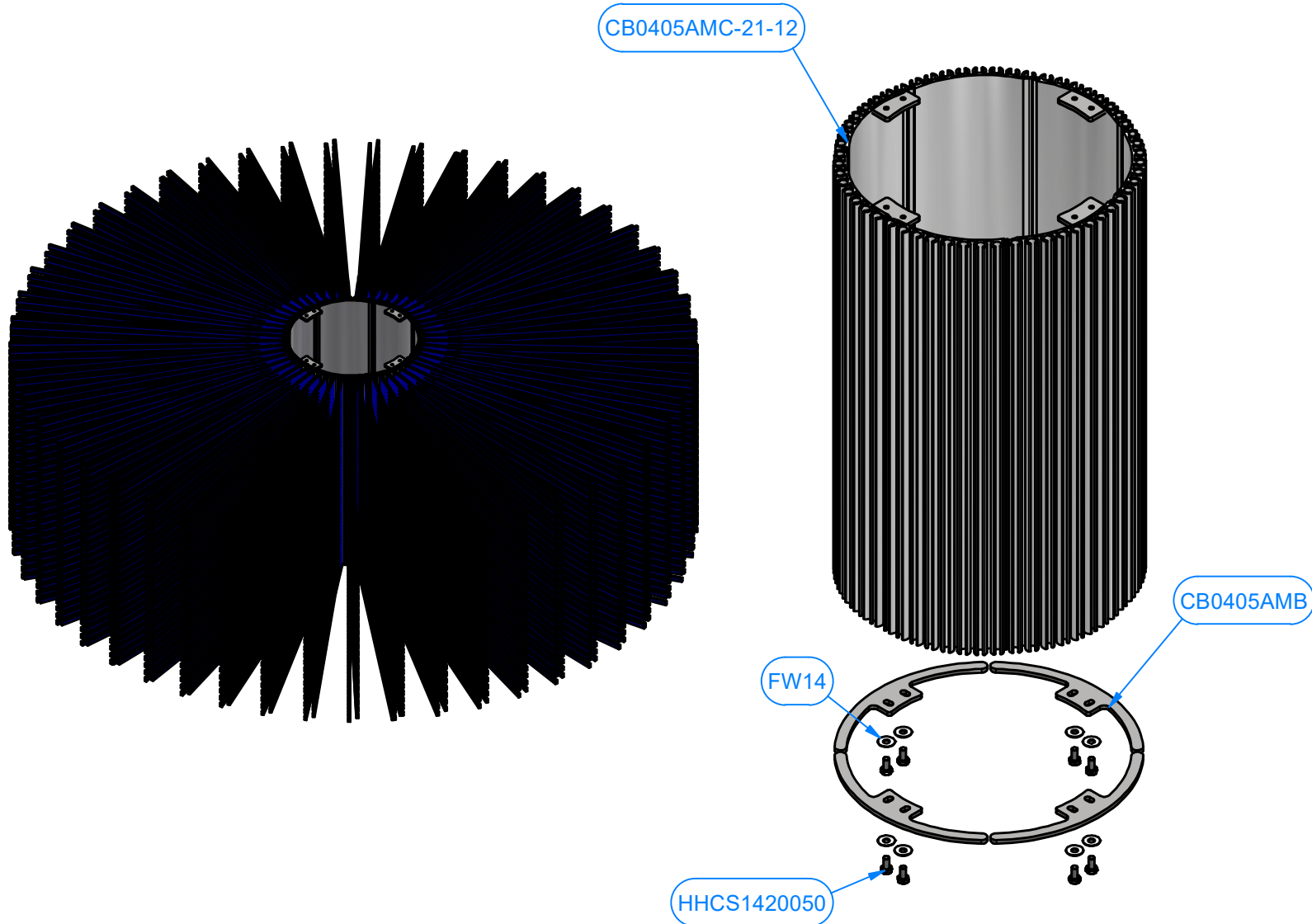

Note: Brush Cloth Sold Separately