



High Pressure Arch_Static

AA2-HP1



High Pressure Arch_Static - AA2-HP1

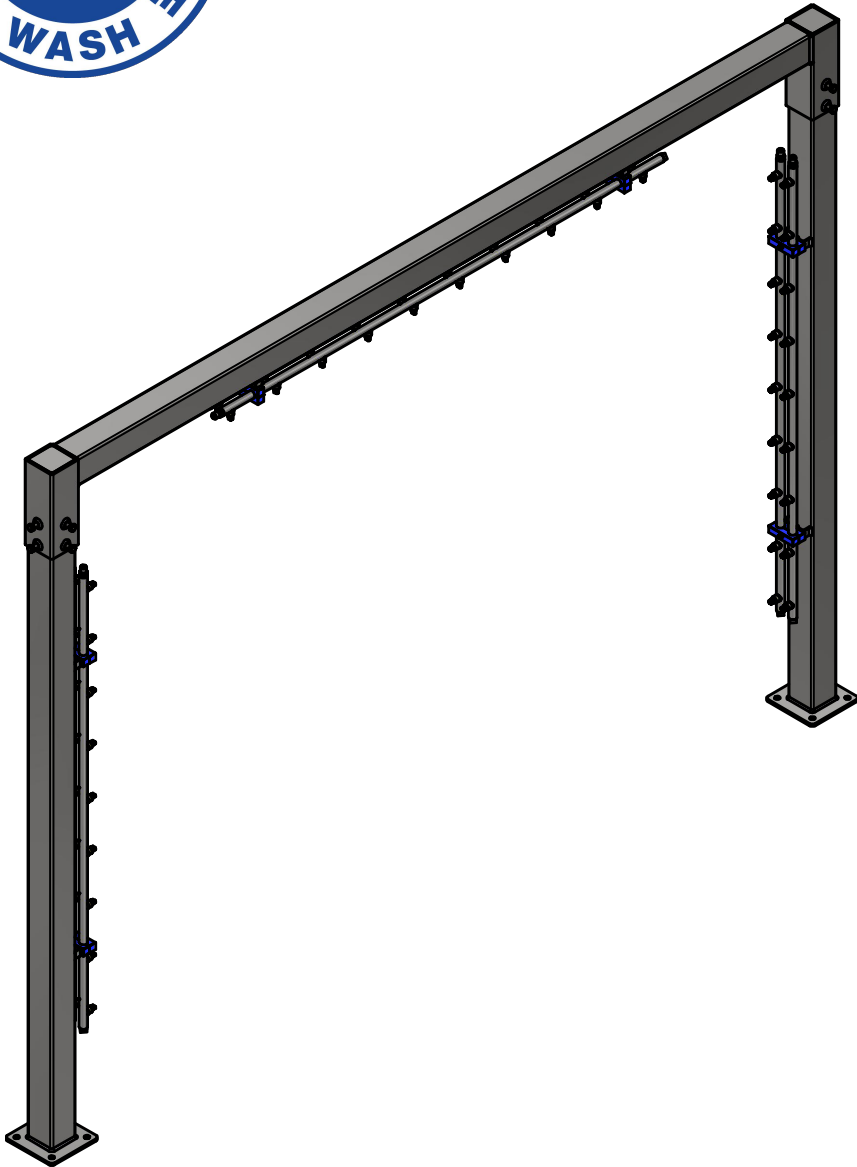

This high-pressure system provides an even spray of the vehicle. Up to 1000 lbs. of pressure. Top manifold blasts the front, top and rear of vehicles. Side manifolds blasts the sides, tires and rocker areas.



High Pressure Arch_Static - AA2-HP1

SPACE REQUIREMENTS

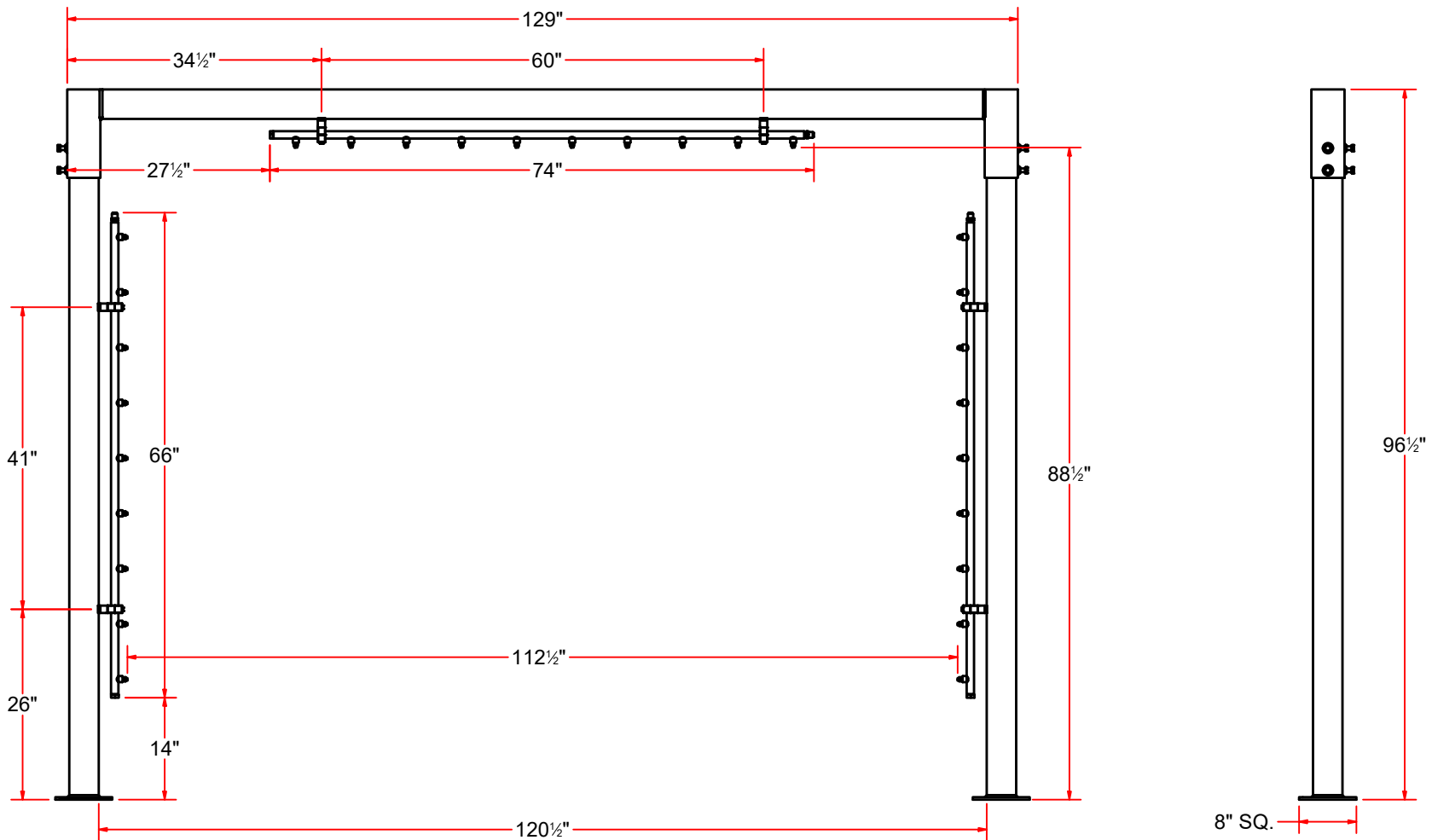

SCALE 9:200



High Pressure Arch_Static - AA2-HP1

Parts List		
PART NUMBER	QTY	DESCRIPTION
AA2HP1B	2	High Pressure Arch Leg Manifold Assembly
AA2HP1A	1	High Pressure Arch Top Manifold Assembly

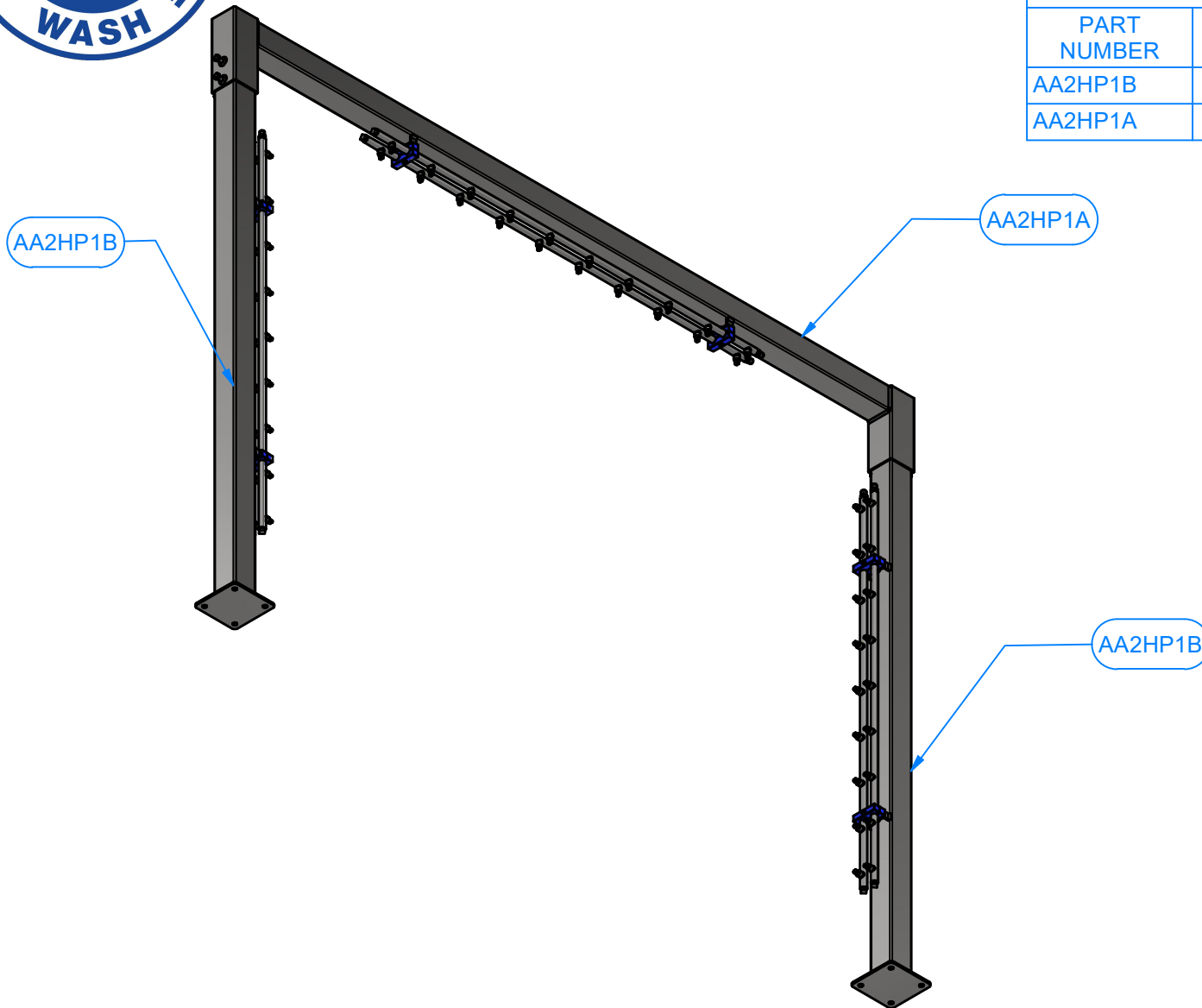



Leg Manifold Assembly - AA2HP1B

Parts List		
PART NUMBER	QTY	DESCRIPTION
AA2HP1BA	1	Leg Assembly
PA1SM	2	Pivoting Arch Side Manifold
HHS1420275	2	1/4" - 20 x 2 3/4" UNC Hex Screw
HN1420	2	1/4"-20 HEX NUT
AA2HP1AA	4	1 in. UHNW Block Half - dual manifolds
FW14	2	1/4" FLAT WASHER

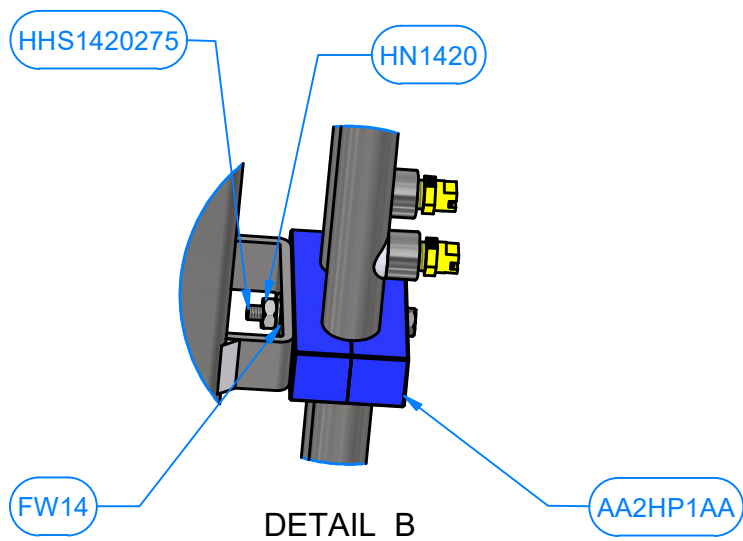
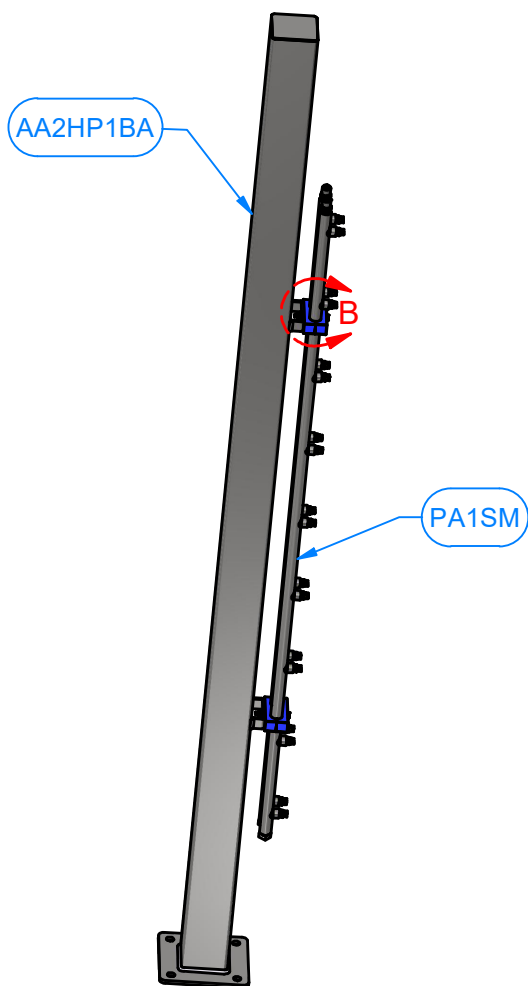



Top Manifold Assembly - AA2HP1A

Parts List		
PART NUMBER	QTY	DESCRIPTION
AA2HP1AB	1	AA2-HP1 - Top Bar Assembly
AA2HP1AA	4	1 in. UHNW Block Half - dual manifolds
HHS1420275	2	1/4" - 20 x 2 3/4" UNC Hex Screw
FW14	2	1/4" FLAT WASHER
HN1420	2	1/4"-20 HEX NUT
PA1TM	2	Pivoting Arch Top Manifold

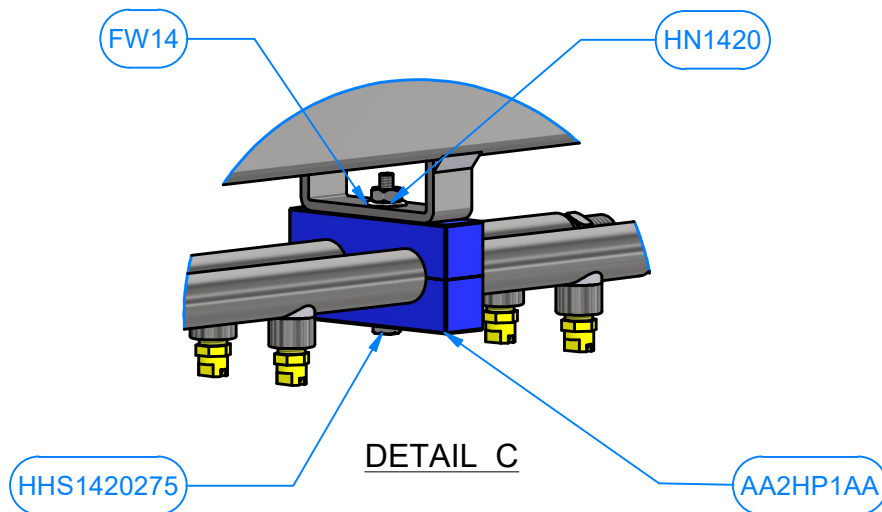
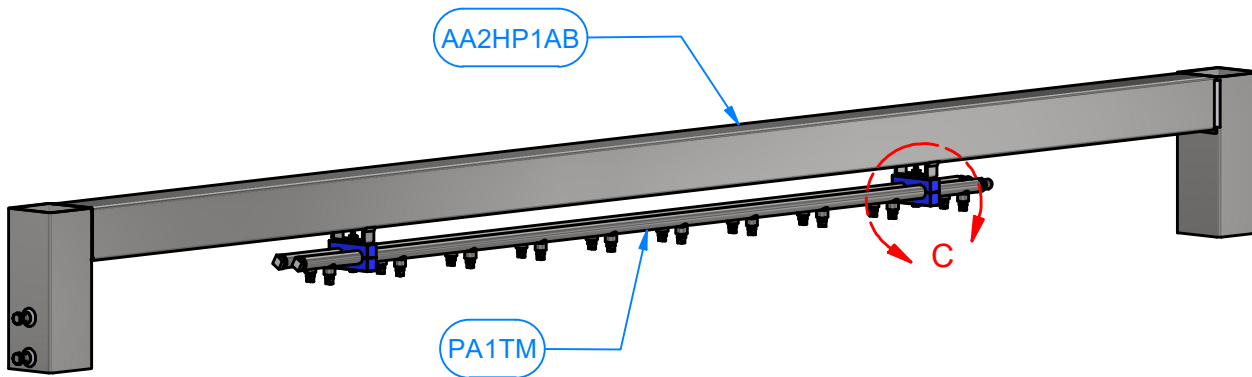



High Pressure Arch_Static - AA2-HP1

EXPLODED VIEW

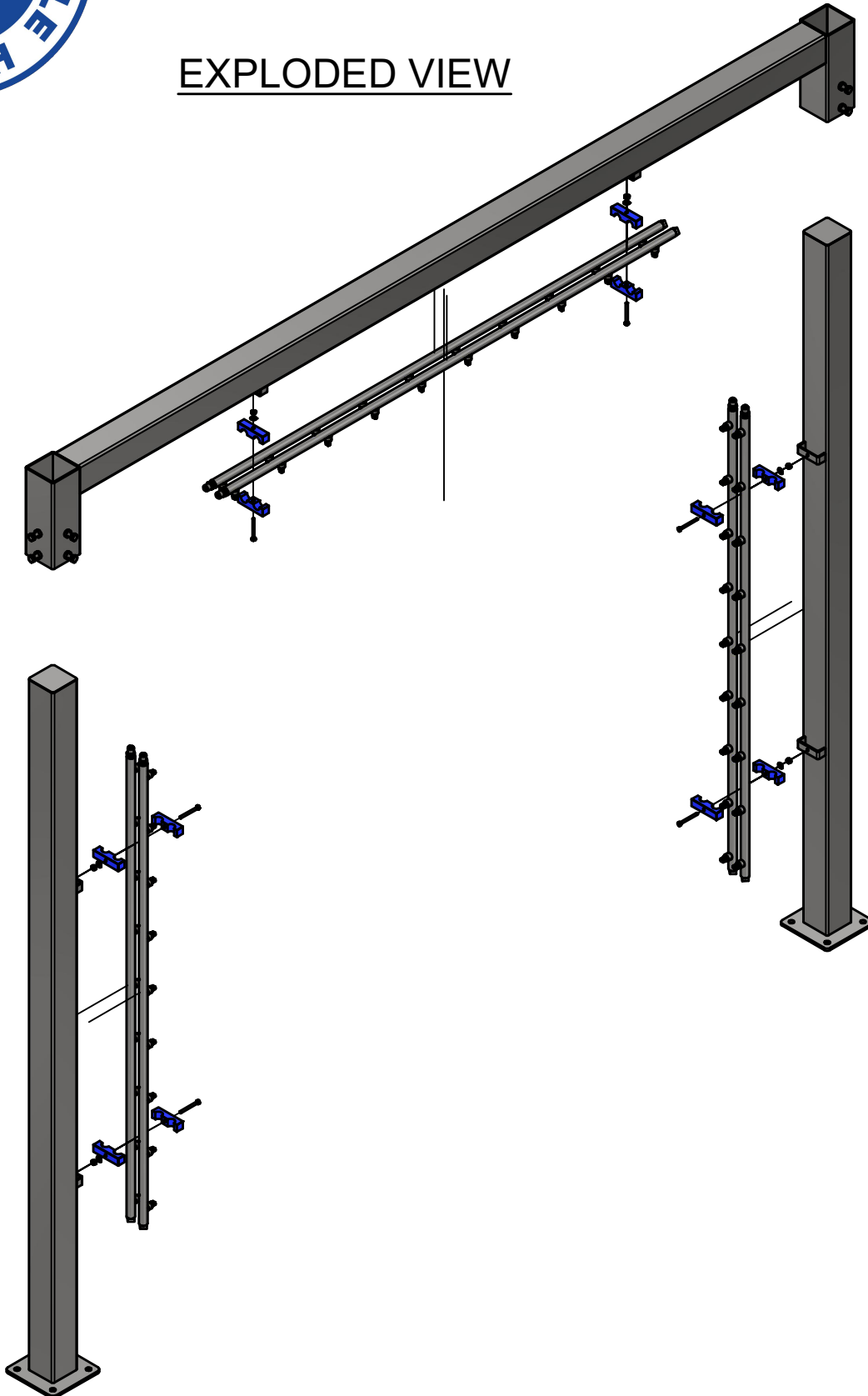

7 of 7